

**This electronic collection of documents is provided
for the convenience of the user
and is Not a Certified Document –**

**The documents contained herein were originally issued
and sealed by the individuals whose names and license
numbers appear on each page, on the dates appearing
with their signature on that page.**

**This file or an individual page
shall not be considered a certified document.**

PROJECT REFERENCE NO.	SHEET NO.
183141075011	X-1
RW SHEET NO.	

DIVISION 14 US 176 TOWN SITES REPAIR CROSS-SECTION INDEX

XS - INDEX	X-1
XS - SUMMARY	X-1A
-SITE 501-	X-2 THRU X-6
-SITE 685 & EP1 (RR) -	X-7 THRU X-13

REVISIONS

10/21/2005
X:\R\6605\Div 14 US 176 Repair\Roadway\XSC\Town Sites\US176 Town Sites_xpl_Index.dgn
lceustma\lce

8/17/99

STATE OF NORTH CAROLINA DIVISION OF HIGHWAYS

PROJ. REFERENCE NO.	SHEET NO.
18314.1075011	X-1A

NOTE: EMBANKMENT COLUMN DOES NOT INCLUDE BACKFILL FOR UNDERCUT

CROSS-SECTION SUMMARY

Station	Uncl. Exc.	Embt												
SITE 501 L501	(cu. yd.)	(cu. yd.)												
11+65.00	0	0												
12+00.00	0	0												
12+50.00	0	1												
13+00.00	0	1												
13+50.00	8	0												
14+00.00	15	0												
14+50.00	15	0												
15+00.00	7	0												
SITE 685 RR	(cu. yd.)	(cu. yd.)												
10+75.00	0	0	Approximate quantities only. Unclassified excavation, fine grading, clearing and grubbing, and removal of existing pavement will be paid for at the lump sum price for "Grading".											
11+00.00	5	0												
11+25.00	5	0												
11+50.00	5	0												
11+75.00	5	0												
12+00.00	4	0												
SITE EF1 RR	(cu. yd.)	(cu. yd.)												
11+75.00	0	0												
12+00.00	6	0												
12+25.00	4	0												
12+50.00	2	1												
12+75.00	2	1												
13+00.00	2	0												
13+25.00	2	0												
13+50.00	1	0												

6/23/16

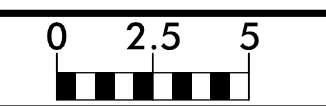

PROJ. REFERENCE NO.	SHEET NO.
18314.1075011	X-2

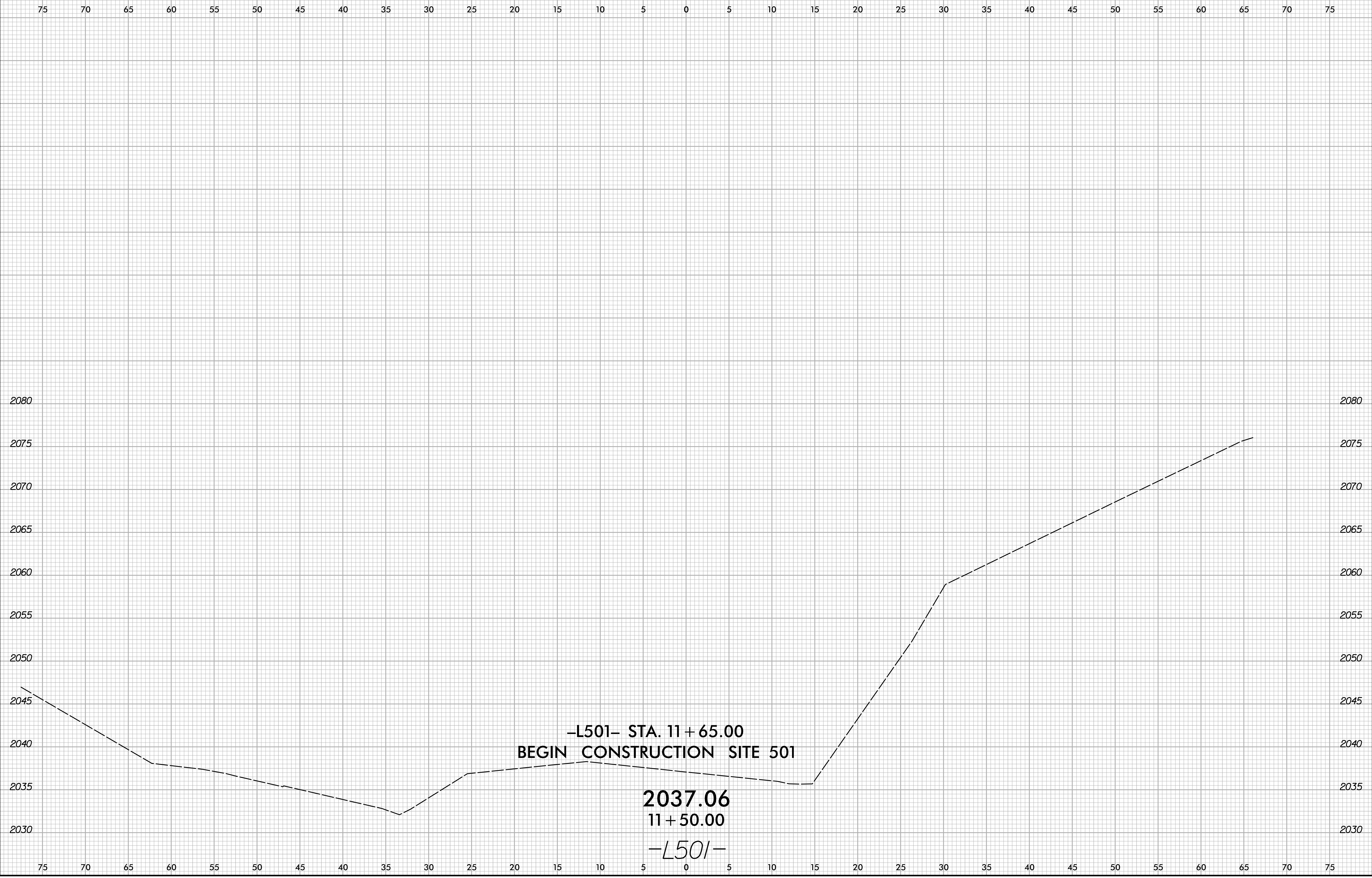

10/21/2025
 X:\NCD00\Div 14 US 176 Repair\Roadway\XSC\Town Sites\US176_Rdy_xpl L501.dgn
 User:rsimelvm

6/23/16
10/21/2025
X:\NC001\Div 14 US 176 Repair\Roadway\XSC\Town Sites\US176_Rdy_xpl L501.dgn
User:rsme14m

0 2.5 5	PROJ. REFERENCE NO. 18314.1075011	SHEET NO. X-3
---------	--------------------------------------	------------------



6/23/16
10/21/2025
X:\NC001\Div 14 US 176 Repair\Roadway\XSC\Town Sites\US176_Rdy_xpl L501.dgn
User:rsimelvm

0 2.5 5	PROJ. REFERENCE NO. 18314.1075011	SHEET NO. X-4
---------	--------------------------------------	------------------

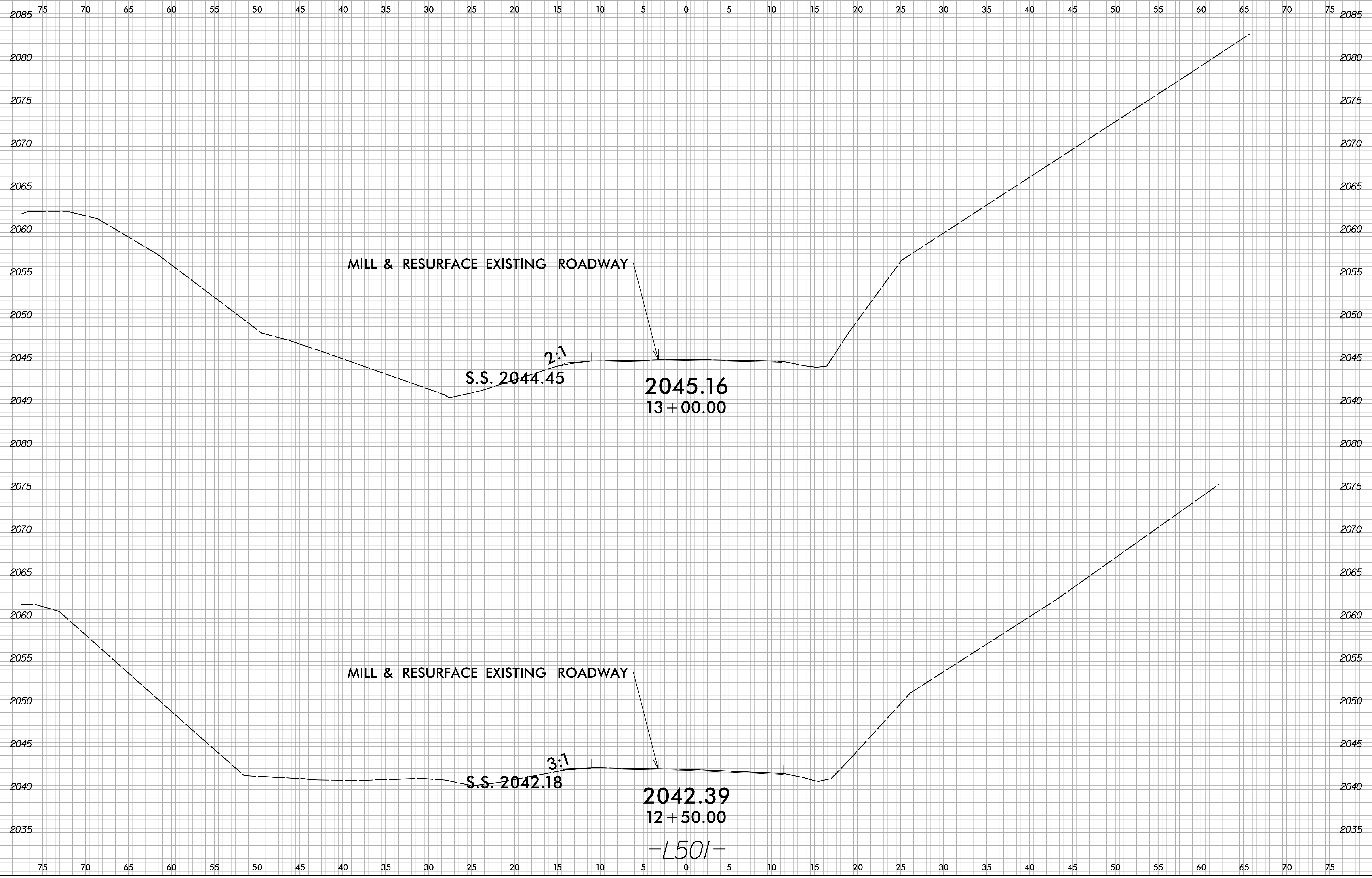

-L501-

6/23/16

0 2.5 5	PROJ. REFERENCE NO. 18314.1075011	SHEET NO. X-5
---------	--------------------------------------	------------------

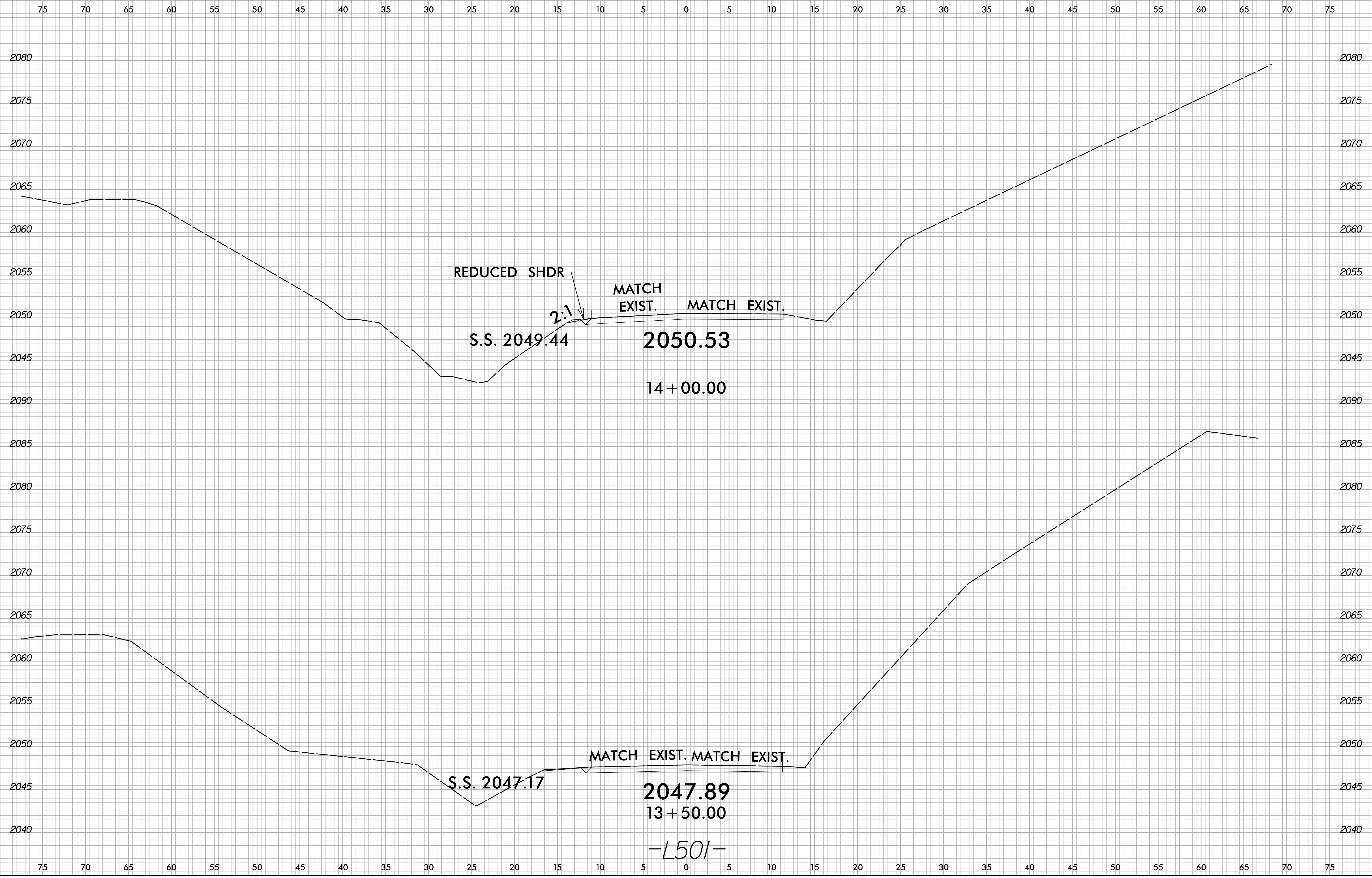

10/21/2025
X:\NCD001\Div 14 US 176 Repair\Roadway\XSC\Town Sites\US176_Rdy_xpl L501.dgn
User:rsmeivm

6/23/16
10/21/2025
X:\NC001\Div 14 US 176 Repair\Roadway\XSC\Town Sites\US176_Rdy_xpl L501.dgn
User:rsme1vm

0 2.5 5	PROJ. REFERENCE NO. 18314.1075011	SHEET NO. X-6
---------	--------------------------------------	------------------

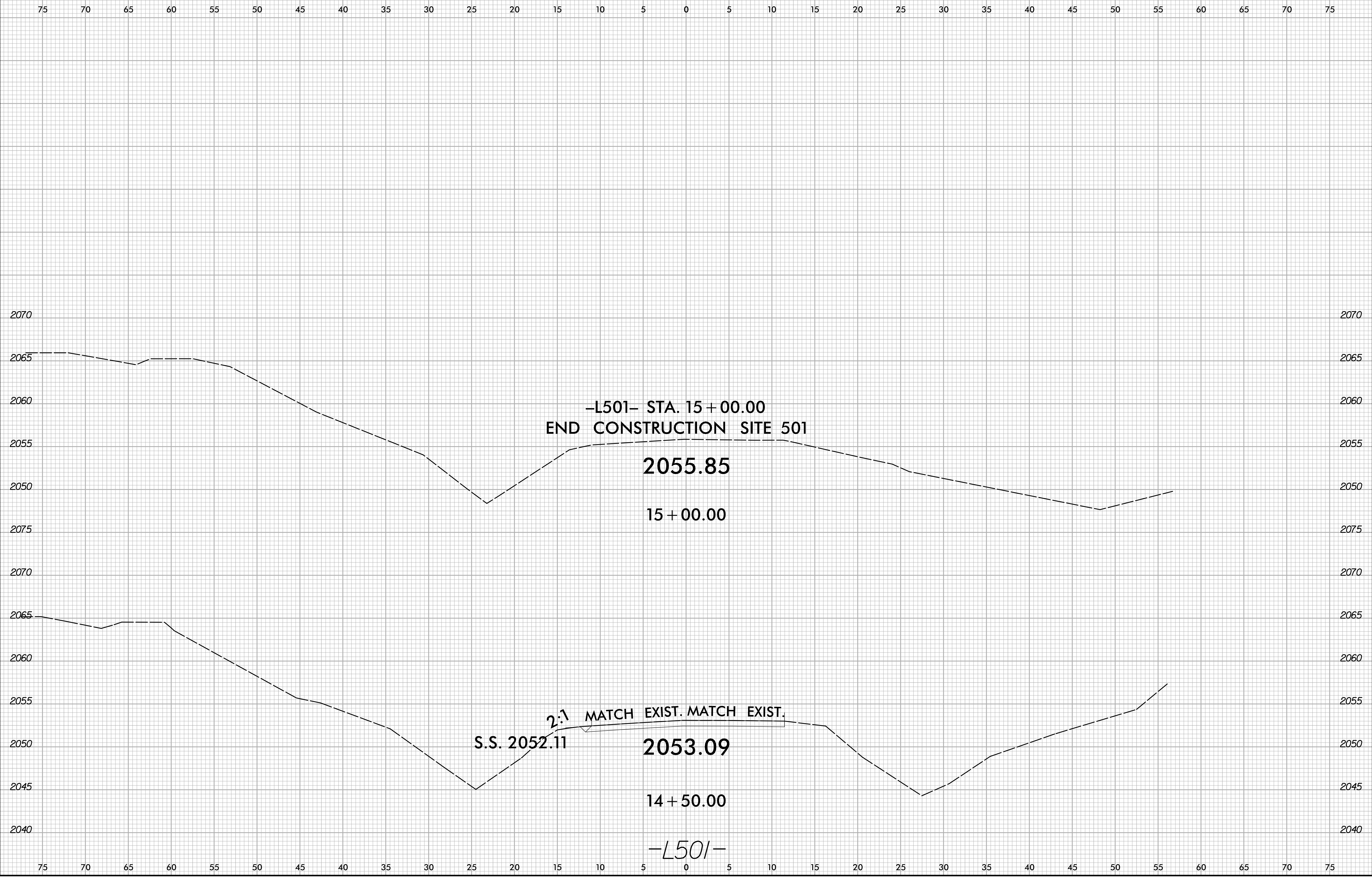

6/23/16
I:\17\2025\17-NC000\17-14 US 176 Repair\Roadway\XSC\Town Sites\US17RR_Rdy_xpl.dgn
User:cbpuect

0 2.5 5	PROJ. REFERENCE NO. 18314.1075011	SHEET NO. X-7
---------	--------------------------------------	------------------

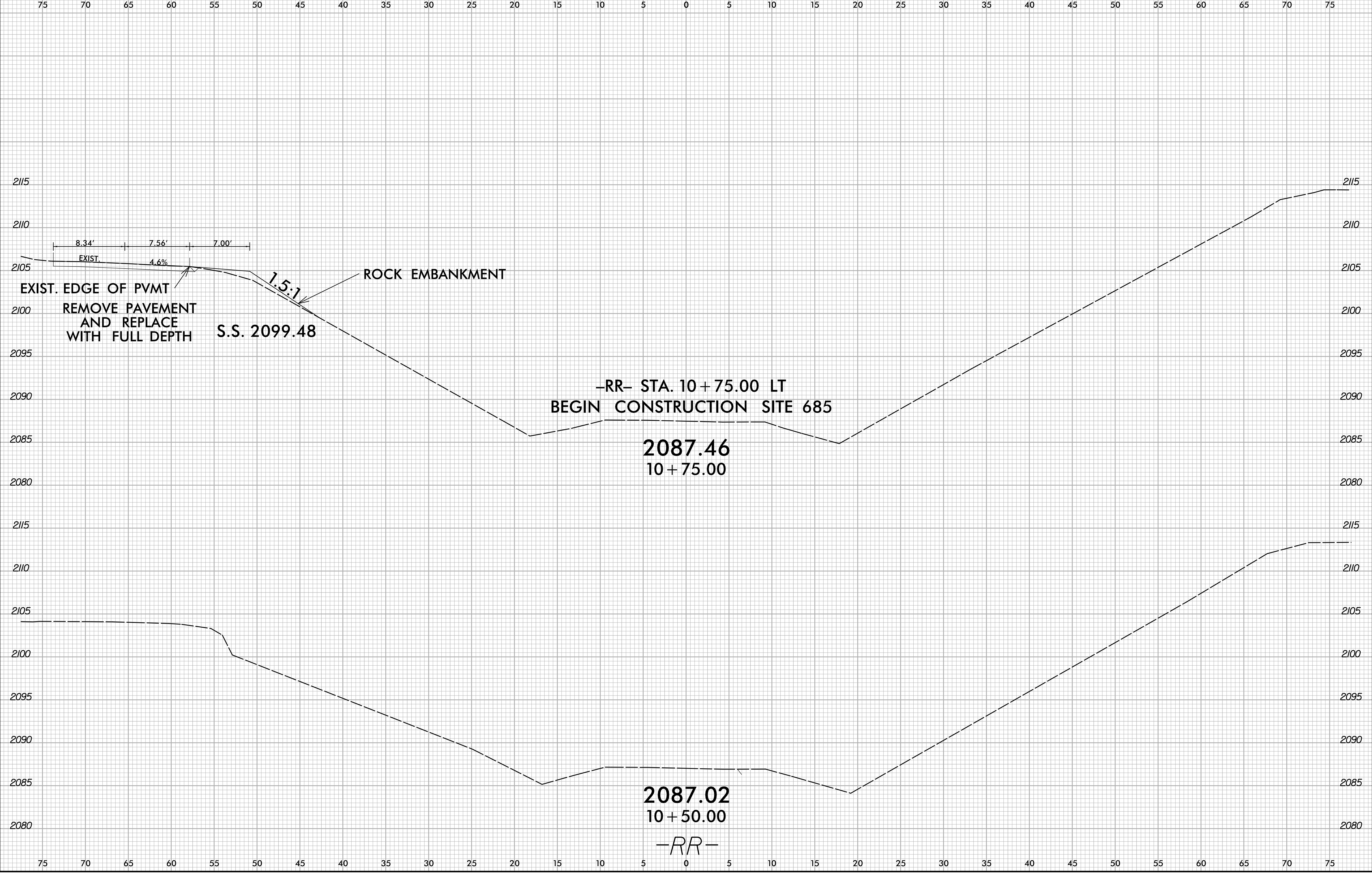

6/23/16
1/17/2025
I:\NC000\Div 14 US 176 Repair\Roadway\XSC\Town Sites\US17RR_Rdy_xpl.dgn
User:rbpruett

0 2.5 5	PROJ. REFERENCE NO. 18314.1075011	SHEET NO. X-8
---------	--------------------------------------	------------------

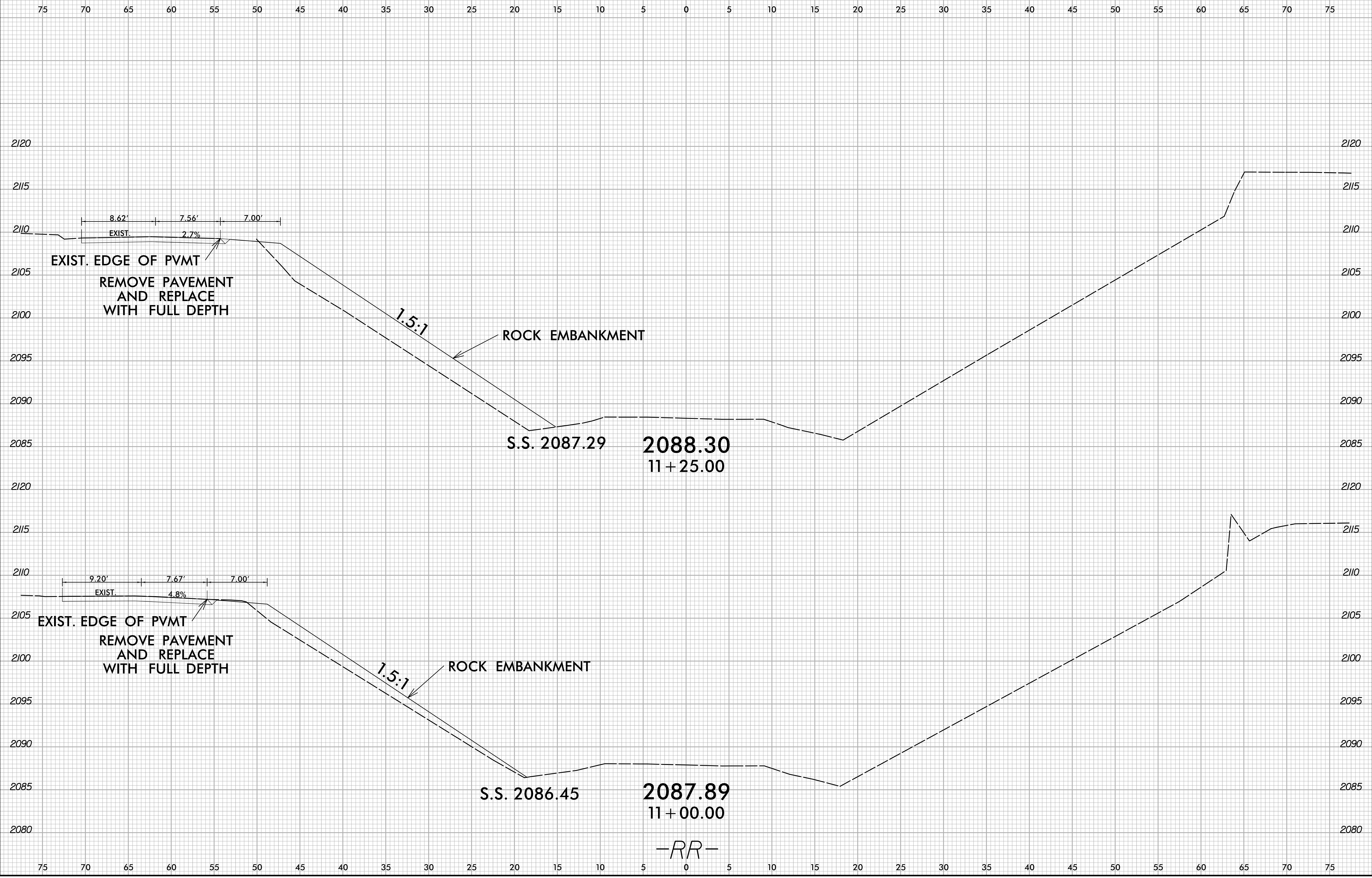

6/23/16
1/17/2025
I:\2025\NCD00\Div 14 US 176 Repair\Roadway\XSC\Town Sites\US17RR_Rdy_xpl.dgn
User:rbpuect

0 2.5 5	PROJ. REFERENCE NO. 18314.1075011	SHEET NO. X-9
---------	--------------------------------------	------------------

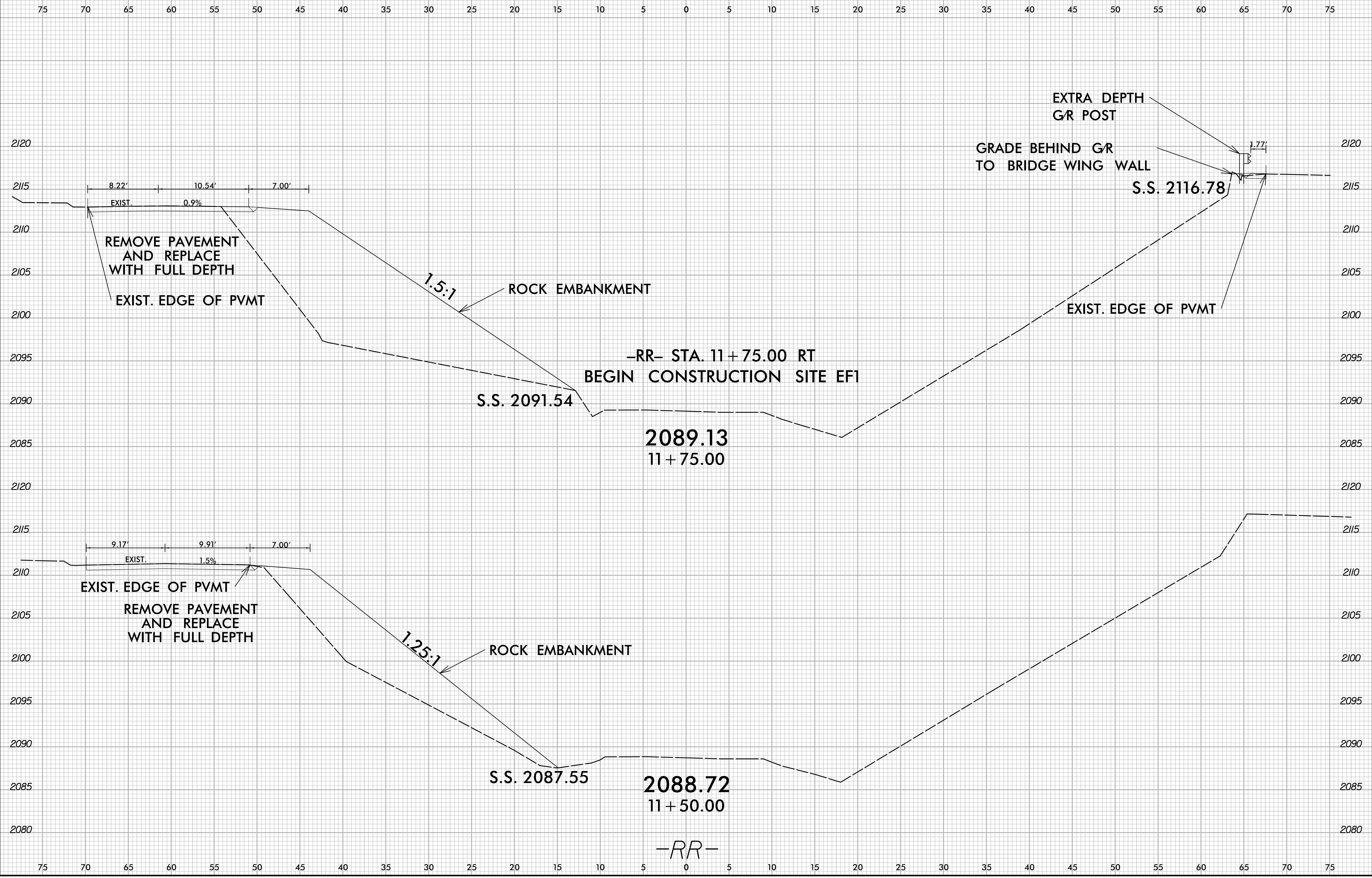

6/23/16
I:\7/2025\Projects\14 US 176 Repair\Roadway\XSC\Town Sites\US17RR_Rdy_xpl.dgn
User:rbpuect

0 2.5 5	PROJ. REFERENCE NO. 18314.1075011	SHEET NO. X-10
---------	--------------------------------------	-------------------

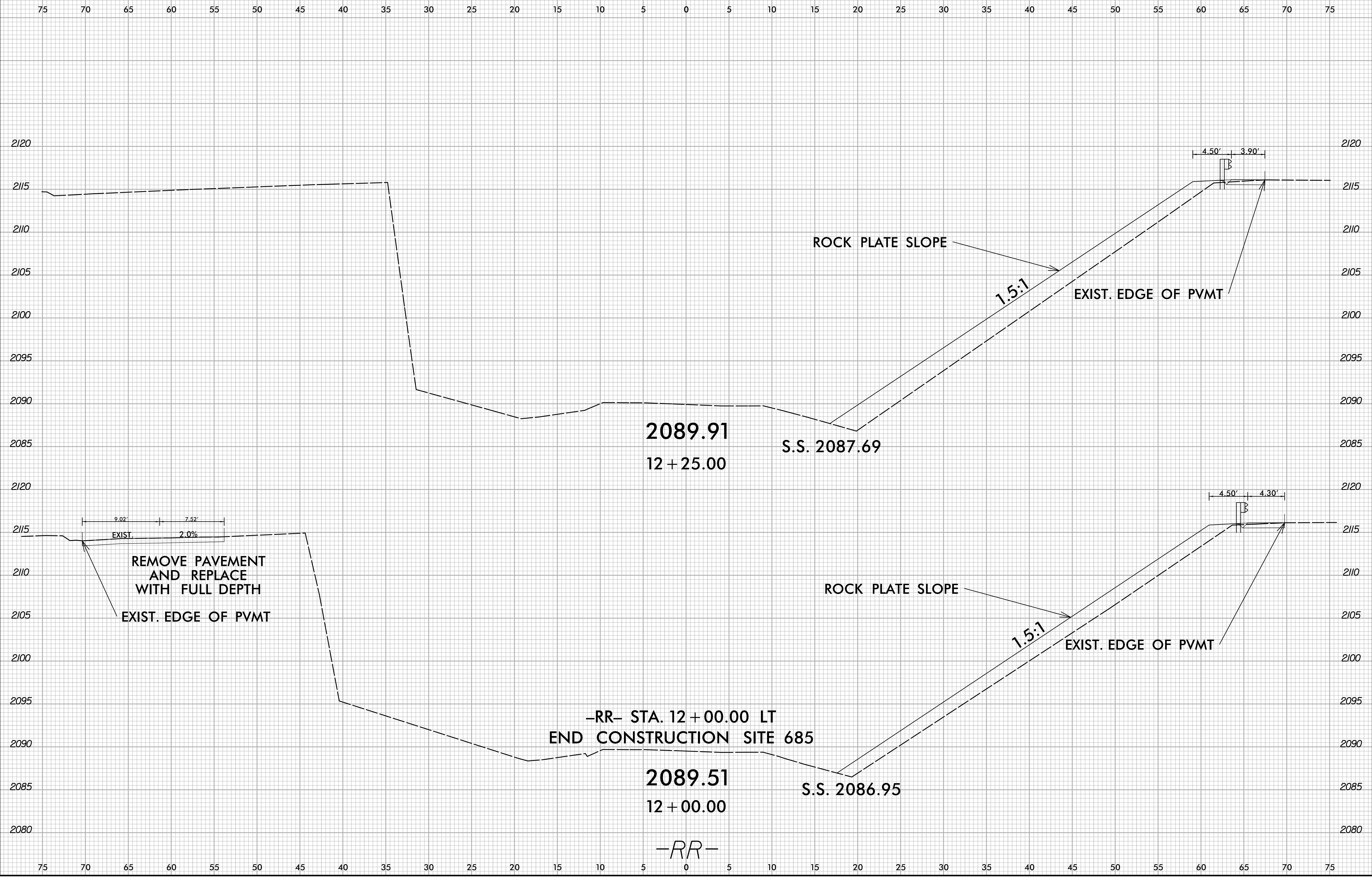

-RR- STA. 12 + 00.00 LT
END CONSTRUCTION SITE 685

2089.91
12 + 25.00

S.S. 2087.69

2089.51
12 + 00.00

S.S. 2086.95

-RR-

6/23/16
10/21/2025
X:\NCD001\Div 14 US 176 Repair\Roadway\XSC\Town Sites\US17RR_Rdy_xpl.dgn
User:rsimplym

0 2.5 5	PROJ. REFERENCE NO. 18314.1075011	SHEET NO. X-11
---------	--------------------------------------	-------------------

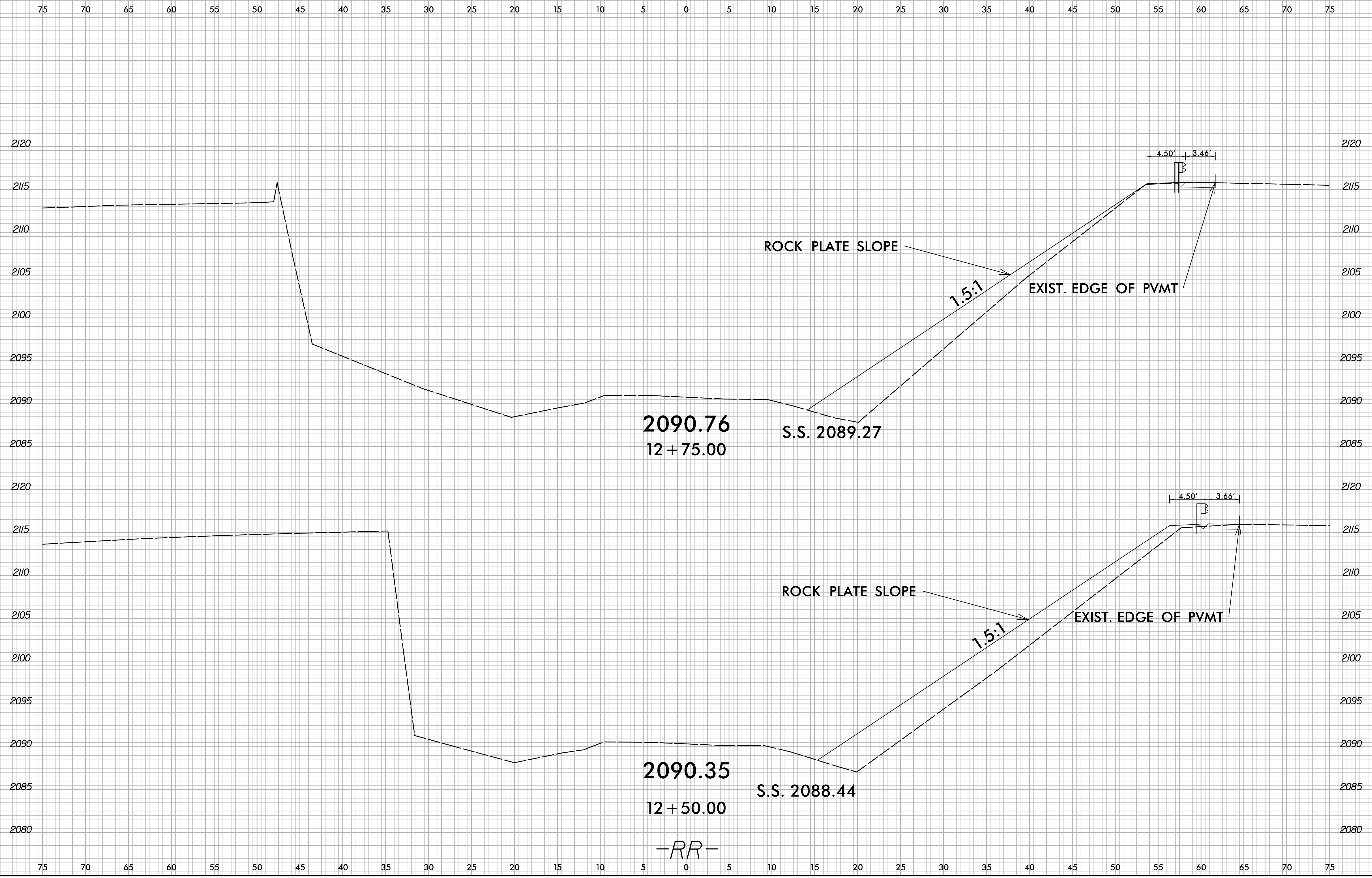

2090.76
12 + 75.00

S.S. 2089.27

2090.35
12 + 50.00

S.S. 2088.44

-RR-

6/23/16
10/21/2025
X:\NCD01\Div 14 US 176 Repair\Roadway\XSC\Town Sites\US17RR_Rdy_xpl.dgn
User:rsme14m

0 2.5 5	PROJ. REFERENCE NO. 18314.1075011	SHEET NO. X-12
---------	--------------------------------------	-------------------

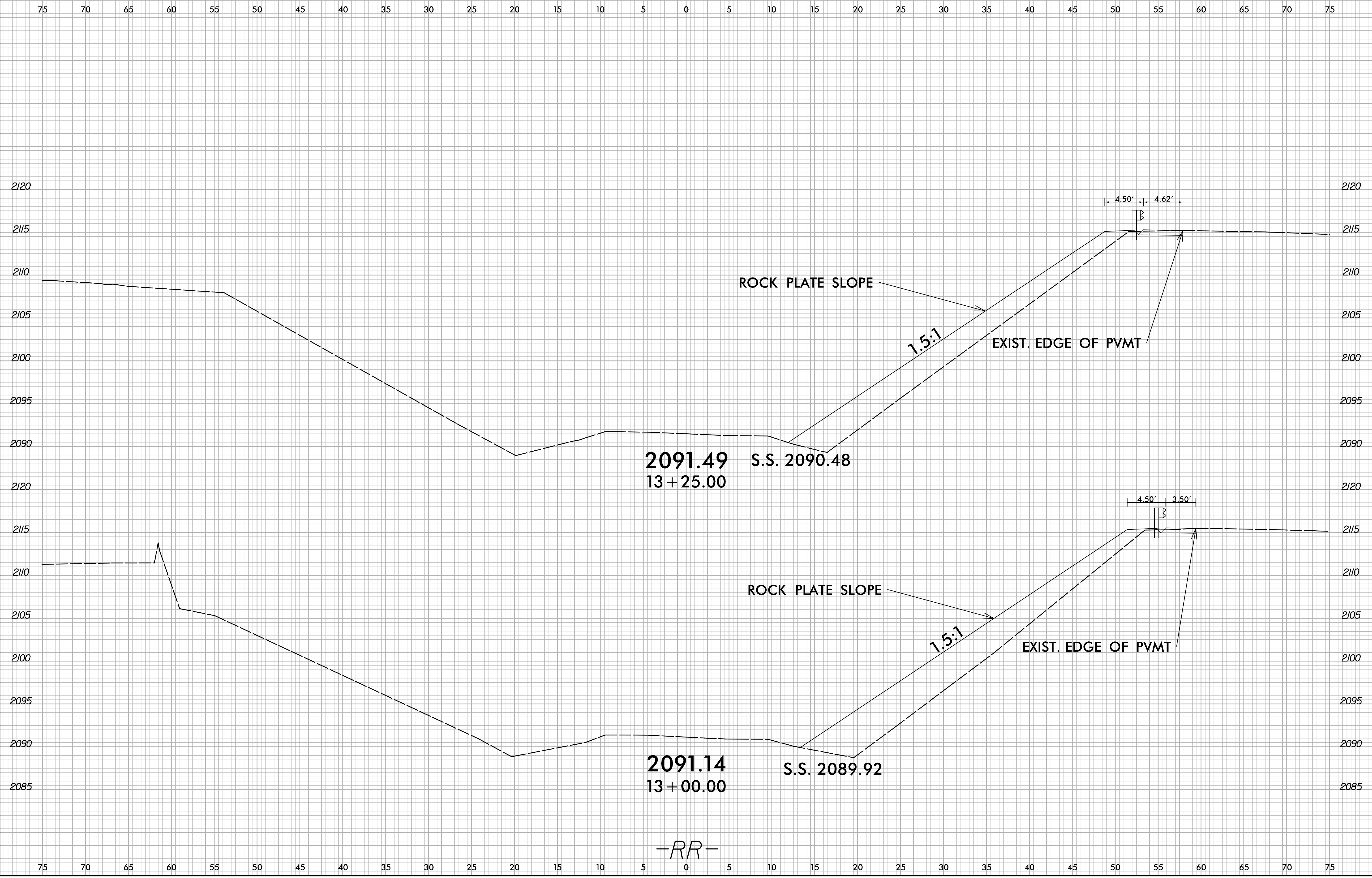

2091.49
13+25.00

S.S. 2090.48

2091.14
13+00.00

S.S. 2089.92

-RR-

6/23/16
10/21/2025
X:\NCD001\Div 14 US 176 Repair\Roadway\XSC\Town Sites\US17RR_Rdy_xpl.dgn
User:rsme14m

0 2.5 5	PROJ. REFERENCE NO. 18314.1075011	SHEET NO. X-13
---------	--------------------------------------	-------------------

